

24 25



AMD

S P O R T S

www.amdsports.ru

SWIX

Workbook
Hardgoods
FW 2425

Perfectly
prepared.

Bringing it to life

Below you'll find products categorized by our three levels:

Black = Statement

Colors = Core

White = Entry

Statement



Core



Entry



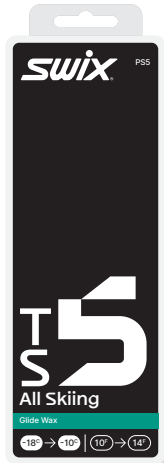

PRO
TOP SPEED

TSP

The TSP series are great powders for competition that work well in fresh, old or man made snow.

The speed of the iron should be approx. 8-10 sec. on a skating ski. Important to have a good iron to get an efficient melting of the powder.

These products will over time get a new design. See and read more about this on page 6-11.

PRO
TOP SPEED

TST

Top Speed Turbo (TST) is a racing wax line developed especially for roto wool application, meaning that waxing iron is not needed.

TST offers a unique combination of water repellency, dirt repellency, durability, and exceptional hardness. This combination makes TST our fastest and most advanced next-generation racing wax.

It can be used as a top coat or base layer under other glide products like TS liquid.



TSP05-4 40 g/1.4 oz. 1 pcs.

TSP05-4
-10°C to -18°C (14 to 0°F)
TSP5 is the hardest powder in the TSP line, and a great choice in cold conditions, both for alpine and cross country. It is loved by servicemen, due to its great durability and dry friction properties. It is made as a powder to make it easier to apply, without sacrificing the great glide properties. For fresh, old or artificial snow. The speed of the iron should be approx. 8-10 sec. on a skating ski. Important to have a good iron to get an efficient melting of the powder. TSP5 can be used as a race powder alone or as a base for top coats.

Recommended iron temp: 160°C (320°F).



TSP06-4 40 g/1.4 oz. 1 pcs.

TSP06-4
-6°C to -12°C (21°F to 10°F)
TSP6 is a very good powder for both alpine and cross country, which has shown great performance on artificial snow in addition to natural snow. The speed of the iron should be approx. 8-10 sec. on a skating ski. Important to have a good iron to get an efficient melting of the powder. TSP6 can be used as a race powder alone, or as base for top coats.

Recommended iron temp: 160°C (320°F).

TST05-2

TS5 TURBO TURQUOISE
-8 °C/-15°C, 20g.



Swix TS5 Turbo is a racing wax for cold and dry snow and temperatures between -8 °C and -15°C. Top Speed Turbo (TST) is the fastest and most advanced next-generation Swix racing wax. TST05 is developed especially for roto wool application.

TST06-2

TS6 TURBO BLUE,
-4°C/-12°C, 20g



Swix TS6 Turbo is a racing wax for medium cold and dry snow and temperatures between -4°C and -12°C. Top Speed Turbo (TST) is the fastest and most advanced next-generation Swix racing wax. TST06 is developed especially for roto wool application.

TST07-2

TS7 TURBO VIOLET,
-2°C/-7°C, 20g



Swix TS7 Turbo is a racing wax for dry snow below the freezing point and temperatures between -2°C and -7°C. Top Speed Turbo (TST) is the fastest and most advanced next-generation Swix racing wax. TST07 is developed especially for roto wool application.

TST08-2

TS8 TURBO RED,
-4°C/+4°C, 20g



Swix TS8 Turbo is a racing wax for dry snow on both sides of the freezing point and temperatures between -4°C and +4°C. Top Speed Turbo (TST) is the fastest and most advanced next-generation Swix racing wax. TST08 is developed especially for roto wool application.

TST10-2

TS10 TURBO YELLOW,
0°C/+10°C, 20g



Swix TS5 Turbo is a racing wax for wet and dirty snow and temperatures between 0°C and +10°. Top Speed Turbo (TST) is the fastest and most advanced next-generation Swix racing wax. TST10 is developed especially for roto wool application.

T18W

ROTO BRUSH MERINO WOOL, 100MM



The World Cup version of roto wool. Longer hair and more fluffy. The first choice for for applying TS Turbo.



TSP07-4 40 g/1.4 oz. 1 pcs.

TSP07-4
 -2°C to -8°C (28°F to 18°F)
 TSP7 is a versatile powder suited for normal winter conditions below the freezing point. Powder makes it convenient to work with and easy to get a good end-result. For fresh, old or man made snow. Good in clean snow. The speed of the iron should be approx. 8-10 sec. on a skating ski. It is important to have a good iron to get an efficient melting of the powder. TSP7 can be used as a race powder alone or as a base for top coats.

Recommended iron temp: 160°C (320°F).



TSP08-4 40 g/1.4 oz. 1 pcs.

TSP08-4
 -4°C to +4°C (25°F to 39°F)
 TSP8 has a softness and racing formula that makes it perfect in conditions on both sides of the freezing point. The speed of the iron should be approx. 8-10 sec. on a skating ski. It's important to have a good iron to get an efficient melting of the powder. TSP8 can be used as a race powder alone, but is often used as a base for top coats

Recommended iron temp.: 160°C (320°F).



TSP10-4 40 g/1.4 oz. 1 pcs.

TSP10-4
 0°C to +10°C (32°F to 50°F)
 TSP10 is made harder than the standard for a 10 wax. The adjusted hardness makes the wax more durable and absorbs less dirt. The solid lubricant additive reduces the friction in contaminated snow. Excellent results in artificial snow as well as natural transformed older snow, especially noticeable when used alone.

Recommended iron temp: 160°C (320°F).



PRO
TOP SPEED LIQUID

TS

High Performance Racing Gliders.
Easy to work with, very time
efficient and extremely durable.

PRO Top Speed liquid racing
gliders that can be used alone, or
as base for SWIX powders and top
coats. The line is
developed in close collaboration
with our World Cup team with
impressive test results.

Recommended for WC and
national level athletes, ambitious
citizen racers and dedicated
enthusiasts.

These products will over time
get a new design. See and read
more about this on page 6-11.

Liquid Waxes

Liquid wax is offering a convenient
alternative to the more labor
intensive hot waxing and is an
alternative to the traditional waxes
in most conditions. However, to
obtain the full effect of the prod-
ucts and preserving the ski base,
hot waxing should be performed
regularly and at least for new or
newly grinded skis.

Liquid Technology

SWIX Liquid TS and HS wax-
es using Bag-on-Valve aerosol
technology are easy to apply and
guarantees high performance for
everybody regardless of waxing
knowledge level.

An advantage from occupational
health point of view is less parti-
cles in the working environment
compared to traditional waxing.
However, it is still important to
wax in a well-ventilated area to
avoid solvent vapors.



TS06L-12 50ml/1.7 US fl.oz. 1 pcs.

TS6 LIQUID BLUE

-4°C to -12°C (25°F to 10°F)

A liquid racing wax with spray-on applicator that
can be used alone or as a base for topcoats.

TS6L is especially developed for colder conditions,
down to minus 12°C (10°F). Below this point liq-
uids are normally outperformed by traditional par-
affin waxes. TS06L is a versatile wax that works in
all snow conditions, but performs at its best when
the humidity is high.



TS07L-12 50ml/1.7 US fl.oz. 1 pcs.

TS7 LIQUID VIOLET

-2°C to -8°C (28°F to 18°F)

A liquid racing wax with spray-on applicator, that
can be used alone or as a base for topcoats.

TS7L performs at it's best when typical winter
conditions are below the freezing point. Can
handle various of snow conditions and are not
humidity sensitive. A safe choice that rarely
underperform within its core area of use.



TS08L-12 50ml/1.7 US fl.oz. 1 pcs.

TS8 LIQUID RED

-4°C to +4°C (25°F to 39°F)

A liquid racing wax with spray-on applicator, that
can be used alone or as a base for topcoats.

TS8L is an extremely versatile wax on both sides
of the freezing point with exceptional feedback
from racing. It performs in older snow below
freezing, new falling snow above and everything
between. Basically a must have in conditions you
will meet often.



TS10L-12 50ml/1.7 US fl.oz. 1 pcs.

TS10 LIQUID YELLOW

0°C to +10°C (32°F to 50°F)

A liquid racing wax with spray-on applicator, that
can be used alone or as a base for topcoats.

TS10L is developed for skiing when the snow is
very wet and transformed. Ideal for spring skiing
when the dirt content typically is high, as it collect
less pollution from the snow than comparable
paraffin waxes. A great choice in warm weather
that never underperforms.

RECOMMENDED BRUSHES



T0018F-2
A fine Roto-fleece for polishing.

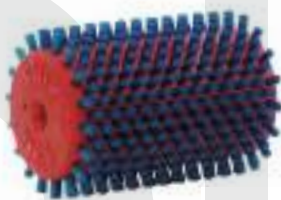

T17W Rotobrush nylon, 100mm



T01900 Oval Fine Red Nylon Brush or
T0190B Rectangular Fine Red Nylon Brush

Statement from our Racing service

Even before the 2022/23 season, we proudly adopted a 100% fluoro-free approach. Our TS range has not only held its own against traditional fluoro products but has thrived for several seasons, becoming a trusted choice in World Cup events, Olympics, and World Championships. While their environmental benefits are commendable, the stellar performance truly captivates our racing community.

As the skiing world navigates new regulations from FIS and IBU, we confidently lead the way. The feedback? Teams unanimously concur: the Swix TS line excels in all snow conditions.

Introducing the Top Speed Turbo (TST): a racing wax specifically crafted for roto-wool application. It's not just the marked efficiency in cold terrains but the distinct "feel" it imparts to skis, particularly during skating, that sets it apart.

Meanwhile, our TS Liquids (TSL) have proven their mettle as a foundational base and a stellar finish. And for those seeking the extra, the TS Powders (TSP) stand out as a standalone or paired with a top finish.

See you in the tracks.

All the best,

Morten Sætha,
Swix Racing Service



Mihhail Lukertsenko
SwixWorld Cup Wax Technician

Morten Sætha
SwixWorld Cup Wax Technician

PRO
HIGH SPEED

HS

The HS series are great gliders for training and competition with very good glide properties.

The speed of the iron should be approx. 8-10 sec. on a skating ski. The wax can be re-heated after cooling to room temperature (10 min.) for better durability. Scraping after approx. one minute.

Important to have a good iron to get an efficient melting of the wax.

These products will over time get a new design. See and read more about this on page 6-11.

PRO
HIGH SPEED LIQUID

HS

Great liquid gliders that are very durable.

Quick and easy to apply. Developed together with our World Cup Racing Service Team, with impressive test results.

Recommended for ambitious citizen racers, dedicated enthusiasts and recreational skiers.



HS05-6	60 g/2.1 oz.	10 pcs.
HS05-18	180 g/6.3 oz.	10 pcs.
HS05-90	900 g/31.5 oz.	1 pcs.

HS5 TURQUOISE
-10°C to -18°C (14°F to 0°F)

HS5 is the hardest wax in the HS line, and is a great choice in cold conditions, due to its great durability and dry friction properties. It's a great choice both for alpine and cross country. Despite being a wax for cold conditions, the melting point makes it easier to apply than many competitors in this area, without sacrificing the great gliding properties. For fresh, old or artificial snow.

HS5 can be used as a race wax alone or as a base for top coats.

Recommended iron temp: 160°C (320°F).

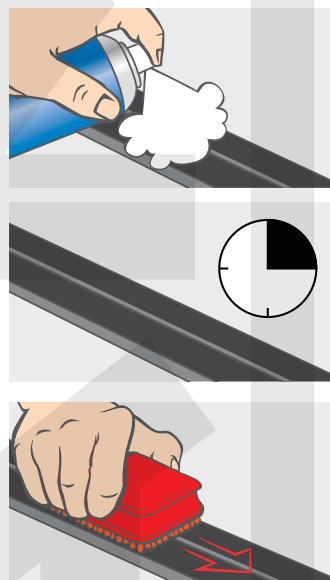

To obtain the best performance it's important to allow the wax film to dry entirely. Apply the product in temperatures above 10°C (50°F) and wait 15 minutes for the film to dry before polishing with a blue nylon brush.

ADD-ON PRODUCT



Rectangular Fine Red Nylon Brush (T0190B) or Oval Fine Red Nylon Brush (T01900).



HS06-6	60 g/2.1 oz.	10 pcs.
HS06-18	180 g/6.3 oz.	10 pcs.
HS06-90	900 g/31.5 oz.	1 pcs.

HS6 BLUE
-6°C to -12°C (21°F to 10°F)

HS6 is very versatile. Its area of use stretches from underlayer for powder to racing wax and base prep wax for cold skis. HS6 has a good durability and offers great performance on natural and artificial snow.

HS6 can be used as a race wax alone or as a base for top coats.

Recommended iron temp: 155°C (311°F).



HS06L-125 125 ml/4.2 US fl. oz. 1 pcs.

HS6 LIQUID BLUE
-4°C to -12°C (25°F to 10°F)

A liquid spray-on training and racing wax that can be used as a race wax alone or as a base for top coats.

HS6L is especially developed for cold conditions, down to -12°C (10°F). Below this point liquids are normally outperformed by traditional paraffin waxes. HS6L is a versatile wax that works in all snow conditions, but performs at its best when the humidity is high.



HS07-6 60 g/2.1 oz. 10 pcs.
HS07-18 180 g./6.3 oz. 10 pcs.
HS07-90 900 g./31.5 oz. 1 pcs.

HS7 VIOLET
 -2°C to -8°C (28°F to 18°F)

HS7 performs great in normal winter conditions below the freezing point. Its hardness makes it convenient to work with and easy to get a good end-result. Can be used as a racing wax at low air humidity, but will also serve the purpose as a brilliant training wax.

HS7 can be used as a race wax alone or as a base for top coats.

Recommended iron temp: 150°C (302°F).



HS08-6 60 g/2.1 oz. 10 pcs.
HS08-18 180 g./6.3 oz. 10 pcs.
HS08-90 900 g./31.5 oz. 1 pcs.

HS8 RED
 -4°C to +4°C (25°F to 39°F)

HS8 is a great wax for both base-prep and training. It can also be used as a race wax, preferably used with a top coat. Easy to melt and very convenient to work with.

HS8 can be used as a race wax alone or as a base for top coats.

Recommended iron temp: 150°C (302°F).



HS10-6 60 g/2.1 oz. 10 pcs.
HS10-18 180 g./6.3 oz. 10 pcs.
HS10-90 900 g./31.5 oz. 1 pcs.

HS10 YELLOW
 0°C to +10°C (32°F to 50°F)

HS10 is a great base prep wax, but also a great training wax. Ideal in warm conditions, typically during spring skiing.

HS10 can also be used as a race wax, preferably used with a top coats.

Recommended iron temp: 150°C (302°F).



HS07L-125 125 ml/4.2 US fl. oz. 1 pcs.

HS7 LIQUID VIOLET
 -2°C to -8°C (28°F to 18°F)

A liquid spray-on training and racing wax that can be used as a race wax alone or as a base for top coats.

HS7L performs at its best when typical winter conditions below the freezing point. Can handle various snow conditions and is not humidity sensitive. A safe choice that rarely underperform within its core area of use.



HS08L-125 125 ml/4.2 US fl. oz. 1 pcs.

HS8 LIQUID RED
 -4°C to +4°C (25°F to 39°F)

A liquid spray-on training and racing wax that can be used as a race wax alone or as a base for top coats.

HS8L is an extremely versatile wax on both sides of the freezing point with exceptional feedback from racing. It performs in older snow below freezing, new falling snow above freezing and everything between. Basically a must have in conditions you will meet often.



HS10L-125 125 ml/4.2 US fl. oz. 1 pcs.

HS10 LIQUID YELLOW
 +2°C to +10°C (36°F to 50°F)

A liquid spray-on training and racing wax that can be used as a race wax alone or as a base for top coats.

HS10L is a wax for very wet conditions when the snow has turned transformed. Ideal for spring skiing when the dirt content typically is high, as HS10L collect less pollution from the snow than comparable paraffin waxes. A great choice in warm weather that never underperforms.

PRO
PERFORMANCE SPEED

PS

The PS series are great gliders for training and competition with good glide properties.

The speed of the iron should be approx. 8-10 sec. on a skating ski. The wax can be re-heated after cooling to room temperature (10 min.) for better durability. Scraping after approx. one minute.

Important to have a good iron to get an efficient melting of the wax.

These products will over time get a new design. See and read more about this on page 6-11.

PRO
PERFORMANCE SPEED

PSL

Our PS Liquid is a new easy to use glide wax for recreational skiing.

These liquid gliders doesn't require using waxing iron or any type of heat.

The 80 ml bottle comes with sponge applicator for easy application on cross country skis.

The 250 ml bottle has a wide opening for easy application on alpine skis.



PS05-6	60 g/2.1 oz.	10 pcs.
PS05-18	180 g/6.3 oz.	10 pcs.
PS05-90	900 g/31.5 oz.	1 pcs.

PS5 TURQUOISE
-10°C to -18°C (14°F to 0°F)

PS5 is the hardest wax in the line, and is a great choice in cold conditions, due to its great durability and dry friction properties. It's a great choice both for alpine and cross country. Despite being a wax for cold conditions, the melting point makes it easier to apply than many competitors in this area, without sacrificing the great glide properties. For fresh, old or artificial snow.

Recommended iron temp: 150°C (302°F).



PS06-6	60 g/2.1 oz.	10 pcs.
PS06-18	180 g/6.3 oz.	10 pcs.
PS06-90	900 g/31.5 oz.	1 pcs.

PS6 BLUE
-6°C to -12°C (21°F to 10°F)

PS6 is very versatile. Its area of use stretches from base for powder to racing wax and base prep wax for cold skis. PS6 has a good durability and offers great performance on natural and artificial snow.

Recommended iron temp: 145°C (293°F).



PS06L-80
PS06L-250

PS6 Liquid Blue, 80ml / 250ml
-6°C to -12°C (21°F to 10°F) 10 pcs.

PS6 liquid is a very versatile liquid glide wax. PS6 liquid provides good durability and excellent glide on natural and artificial snow. PS6 can be used as a racing wax alone or as a base wax for final wax layers.

PS06L-80 comes in a 80 ml bottle with an applicator for easy application on cross country skis. Applies to all 80ml (6-10). PS06L-250 comes in a 250 ml bottle with a wide opening for easy application on alpine skis.



PS07L-80
PS07L-250

PS7 Liquid Violet, 250ml / 80ml
-2°C to -8°C (28°F to 18°F) 10 pcs.

PS7 liquid is a very versatile liquid glide wax. PS7 liquid provides good durability and excellent glide on natural and artificial snow. PS7 can be used as a racing wax alone or as a base wax for final wax layers. PS07L-250 comes in a 250 ml bottle with a wide opening for easy application on alpine skis and snowboards.



PS08L-80
PS08L-250

PS8 Liquid Red, 80ml/250ml
-4°C to +4°C (25°F to 39°F) 10 pcs.

PS8 liquid is a very versatile liquid glide wax. PS8 liquid provides good durability and excellent glide on fine grained snow. PS10 can be used as a racing wax alone or as a base wax for final wax layers. PS08L-80 comes in a 80 ml bottle with an applicator for easy application.



PS10L-80
PS10L-250

PS10 Liquid Yellow, 80ml/250ml
0°C to +10°C (32°F to 50°F)
10 pcs.

PS10 liquid is a very versatile liquid glide wax. It provides good durability and excellent glide on fine grained snow. PS10 can be used as a racing wax alone or as a base wax for final wax layers. PS10L-80 comes in a 80 ml bottle with an applicator for easy application.



PS07-6 60 g/2.1 oz. 10 pcs.
PS07-18 180 g/6.3 oz. 10 pcs.
PS07-90 900 g/31.5 oz. 1 pcs.

PS7 VIOLET
 -2°C to -8°C (28°F to 18°F)

PS7 is a wax that performs great in normal winter conditions below the freezing point. Its hardness makes it convenient to work with and easy to get a good end-result. PS7 is an economic training and racing wax as well as an all round base prep wax.

Recommended iron temp: 140°C (284°F).



PS08-6 60 g/2.1 oz. 10 pcs.
PS08-18 180 g/6.3 oz. 10 pcs.
PS08-90 900 g/31.5 oz. 1 pcs.

PS8 RED
 -4°C to +4°C (25°F to 39°F)

PS8 is an economic training and racing wax as well as base prep wax for warm skis. Easy to melt and very convenient to work with.

Recommended iron temp: 130°C (266°F).



PS10-6 60 g/2.1 oz. 10 pcs.
PS10-18 180 g/6.3 oz. 10 pcs.
PS10-90 900 g/31.5 oz. 1 pcs.

PS10 YELLOW
 0°C to +10°C (32°F to 50°F)

PS10 is an economic training and racing wax as well as base prep wax for warm skis. Easy to melt and very convenient to work with.

Recommended iron temp: 120°C (248°F).

APPLICATION

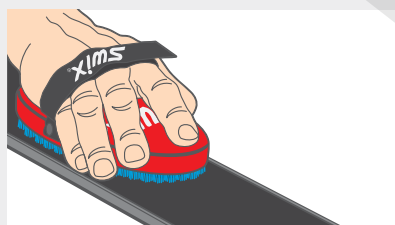
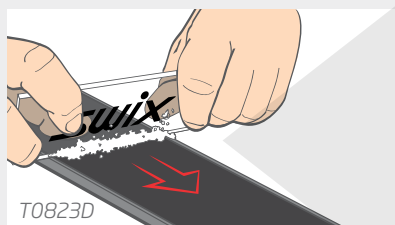
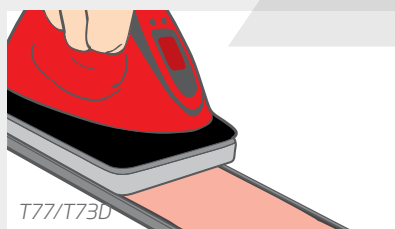
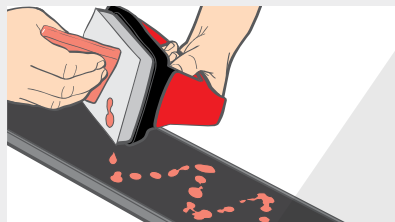

PSP-3 30 g/1.06 oz. 10 pcs.

PS POLAR POWDER
 -14°C/-32°C (7°F to -26°F).

PSP is a special powder wax to add to other waxes to increase their durability, and to protect the base from ice abrasion.

For especially abrasive snow, such as new artificial snow, apply the wax of choice and then iron. While the wax is still in liquid form, or at least still warm, sprinkle the PSP powder over the wax. Even a generous amount will not effect glide. Then iron the powder into the wax layer. Allow cooling, then scrape and brush away the excess.

Recommended iron temp: 150°C (302°F).



PSP-6 60 g/2.1 oz. 10 pcs.
PSP-18 180 g/6.3 oz. 10 pcs.

PS POLAR
 -14°C/-32°C (7°F to -26°F).

PS Polar is a wax for extreme cold conditions, which can perfectly be used alone as a race wax when the air humidity is low. It performs very well on artificial snow and has a great durability

The speed of the iron should be approx. 8-10 sec. on a skating or alpine ski.

The wax can be re-heated after cooling to room temperature (10 min.) for better durability. Scraping after approx. one minute. It's important to have a good iron to get an efficient melting of the wax. In the warmer part of the temperature range, and when high air humidity, a powder or other top coat product will increase the performance.

Recommended iron temp: 155°C (311°F).

BP

Special base glide waxes for a racing and performance oriented level.

Base prep waxes should be used as prep wax before applying wax of the day.

These products will over time get a new design. See and read more about this on page 6-11.



BP077-18 180 g./6.3 oz. 10 pcs.
BP077-900 900 g./31.5 oz. 1 pcs.

BASE PREP COLD

A harder Baseprep for new DH, GS and SL skis used for all conditions. Can also be used for glacier training. The wax is easy to work with and gives the ski bases a nice looking finish.

BP088-180 180 g./6.3 oz. 10 pcs.
BP088-900 900 g./31.5 oz. 1 pcs.

BASE PREP

Normal. For normal winter conditions, 0°C to -10°C (32°F to 14°F). The All Round Base Prep wax for most skis/boards. Used on new skis and as travel wax.



BP099-18 180 g./6.3 oz. 10 pcs.
BP099-900 900 g./31.5 oz. 1 pcs.

BASE PREP WARM

Soft wax with low melting point. Recommended as the first wax on all new skis to make the base accustomed to hot irons.

BP99 is also recommended for skis or boards in the "Hot Box". The temperature in the Hot Box should never be higher than 55°C/130°F. Higher temps than 55°C in the hot box can cause delamination of the base.

BPL-500 500 ml/16.9 US fl. oz. 1 pcs.
BPL-80 80 ml/2.7 US fl. oz. 10 pcs.

BASE PROTECTION LIQUID

Liquid transportation wax. Leaves a thin layer of wax when the solvent evaporates. 80 ml. bottle with sponge applicator for easy application. 500 ml. bottle to be used as a refill station for BPL-80.

The unique wax

Hard and extra durable glide waxes.

Great test results!

- Easy application with roto- wool
- No temperature intervals
- Snow type and conditions decides



Newer and clean snow



Dirty contaminated snow



Great for cold application with roto-wool

PRO Marathon Glide Wax

These products will over time get a new design. See and read more about this on page 6-11.

DHFF-4 DHP-4



Marathon	40 g/1.4 oz.	1 pcs.
Marathon Powder	40g/1.4 oz.	1 pcs.

A hard and extra durable glide wax for long distance racing. Developed especially for longer distances in newer and clean snow. Great in warmer conditions, but often competitive also in colder weather. The speed of the iron should be approx. 8-10 sec. on a skating ski. The wax can be re-heated after cooling to room temperature (10 min) for better durability. Scraping after approx. one minute. Important to have a good iron to get an efficient melting of the wax.

Marathon waxes can be used as a race wax alone or as a base for top coats.

Recommended iron temp: 155°C (311°F).

NEW

DHB-23-4 DHPB-23-4



Marathon Black	40 g/1.4 oz.	1 pcs.
Marathon Black Powder	40g/1.4 oz.	1 pcs.

A hard and extra durable glide wax with additive for long distance racing. Developed especially for wet dirty contaminated snow. The additive is reducing friction against dirt particles. Great in warmer conditions, but often competitive also in colder weather. The speed of the iron should be approx. 8-10 sec. on a skating ski. The wax can be re-heated after cooling to room temperature (10 min) for better durability. Scraping after approx. one minute. Important to have a good iron to get an efficient melting of the wax.

Marathon waxes can be used as a race wax alone or as a base for top coats. NBI For FW24/25 Marathon Black has a new and improved recipe.

Recommended iron temp: 155°C (311°F).

Roto wool application

A new and revolutionary easy way to apply TS Turbo and other hard glide waxes. Wool application has been used a lot for racing in the last seasons. It gives a very good feeling on the skis. It is also a very efficient way to apply wax on the skis. For maximum performance, we highly recommend using a drill machine with a minimum rotation speed of 1800 rpm. On pre-waxed bases we recommend applying TS Turbo or Marathon as a top coating, using a roto wool for the best performance. No ironing, and no polish brushing needed.

- 1: Clean and refresh the base structure lightly with a fine steel brush. We recommend T0191B since it cleans deep into the ski base structure.
- 2: Apply the Marathon glider to the roto wool by pressing the wax block against half the width of the roto wool while running the drill at a low speed.
- 3: Use the waxed side of the roto wool on the ski with medium pressure and medium drill speed. Start with the back of the ski, and continue with the front.
- 4: Finish off by polishing the whole ski with the clean side of the roto wool. Use very light pressure and maximum drill speed.

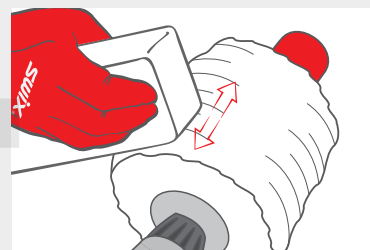
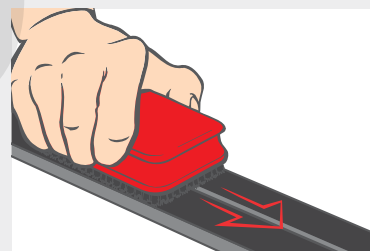

T18W Roto brush merino wool, 100 mm



BIOG4-6 Bio-G4 Performance Wax, 60g, 10pcs.
BIOG4-18 Bio-G4 Performance Wax, 180g, 10pcs.
BIOG4-900 Bio-G4 Performance Wax, 900g, 1pcs.

-20°C to -10°C

BIOG4 is a hard wax that covers cold temperatures from -20°C to -10°C

BIOB6-6: Bio-B6 Performance Wax, 60g, 10pcs.
BIOB6-18: Bio-B6 Performance Wax, 180g, 10pcs.
BIOB6-900: Bio-B6 Performance Wax, 900g, 1 pcs.

-12°C to +2°C

BIOB6 covers the typical winter temperatures from -12°C to +2°C.

BIOR8-6 Bio-R8 Performance Wax, 60g, 10pcs.
BIOR8-18 Bio-R8 Performance Wax, 180g, 10pcs.
BIOR8-900 Bio-R8 Performance Wax, 900g, 1 pcs.

-2°C to +10°C.

BIOR8 covers warm temperatures from -2°C to +10°C.

Produced by Swix in Lillehammer

Perfectly Prepared to stay

Fluoro Free



Introducing the Swix 100N Ski Wax: Your Natural Performance Solution

Elevate your skiing experience with the revolutionary Swix 100N – a cutting-edge formula meticulously crafted from 100% natural ingredients. Comprising a harmonious blend of ethically and sustainably sourced carnauba wax, sunflower seed wax, beeswax, and juniper oil, this creation embodies our commitment to both performance and environmental responsibility.

Unlock the Power of Nature

Each ingredient in Swix 100N Ski Wax is thoughtfully selected, ensuring a ski wax that not only enhances your glide but also preserves the planet we cherish. We've taken an extra step by infusing a touch of juniper oil, handpicked and distilled in the breathtaking landscapes of Alvdal, Norway. This natural antiseptic oil brings a fresh scent while enriching the wax with superior rheological properties.

Peak Performance, Every Descent

Experience the alpine world like never before with the Swix 100N advantage. Our expertly balanced combination of natural waxes guarantees exceptional performance across all snow conditions. Whether you're carving down the slopes or embracing the backcountry, the Swix 100N Ski Wax empowers you to conquer with confidence.

Simplicity in Application

Effortless application is at your fingertips. The Swix 100N Ski Wax is designed for ease, making your pre-adventure routine smooth and hassle-free. Applying, scraping off, and brushing the wax is a breeze, allowing you more time to relish every exhilarating moment on the mountain.

A Versatile Choice

Tailored to meet the needs of alpine skiers, snowboarders, and cross-country enthusiasts alike, Swix 100N Ski Wax offers unbeatable versatility. From the meticulously groomed slopes to the untouched serenity of the backcountry, trust in Swix 100N to elevate your performance to new heights.

Join the Movement

Embrace the natural evolution of skiing performance. Choose Swix 100N Ski Wax and embark on a journey that melds excellence, sustainability, and the unspoiled beauty of our world's snowy landscapes.

Elevate your glide. Elevate your journey. Swix 100N Ski Wax – Naturally Unleashed.



100N-24-60 100N NATURAL WAX, 60G
100N-24-180 100N NATURAL WAX, 180G





F4-23-100 F4 Glidewax Liquid 100ml, 21 pcs.
F4-23-250 F4 Glidewax Liquid 250ml, 10 pcs.

F4-23-100 has a sponge foam applicator on one side of the bottle for applying wax, and a felt pad on the other side for polishing. A handy pocket-size.

F4-23-250 comes in a bottle with a wide opening for easy application on alpine skis.

Apply a thin layer over the base surface. Let it dry for approx. 2 minutes. Finish by polishing with the felt pad. Apply F4 to the steel edges when storing your skis or board after the season. This prevents the edges rusting.



F4-23-180 F4 Glidewax 180g, 10 pcs.
F4-23-900 F4 Glidewax 900g, 1 pcs.

F4-23-180 and F4-23-900 is intended for heat application with a waxing iron. The temperature of the waxing iron is 130°C. Scrape off excess wax with plexi scraper T0823D and finish off with combi brush T0159B.



T0149-F4 F4 Tuning Vise

F4, two-piece vise based on friction. For freeride and alpine skis. Option to work on side edges. Lightweight and compact, made of rock-solid ballistic plastic. Easy to bring while traveling.



F4-23-150 F4 Glidewax Aerosol 150ml, 10 pcs.

F4-23-150 has a sponge foam applicator for wax application. Apply a thin layer over the base. Let it dry for approx. 5 minutes. Finish by polishing with Fiberlene T0151 or Nylon Brush T0166B. Apply F4 to the metal edges before storing your skis or board after the season. This prevents the edges rusting.



F4-23-40 F4 Glidewax Paste 40g, 10 pcs.
F4-23-75 F4 Glidewax Paste 75ml, 20 pcs.

F4-23-40 and F4-23-75 has a foam applicator for applying wax. Apply a thin layer over the base. Let it dry for approx. 5 minutes. Finish by polishing with Fiberlene T0151 or Nylon Brush T0166B. Apply F4 to the metal edges before storing your skis or board after the season. This prevents the edges rusting.



F4-23-60 F4 Glidewax Rub-on w/cork 60g, 10 pcs.

The F4-23-60 has cork on the back-side of the box. Rub or dab the glide wax on the base. Polish the wax and the base with the cork.

SU-1 Surmount Alpine Ski Touring Kit, 1 pcs.

Surmount ski touring kit is equipped with essential products for a great day up in the mountains. The kit contains a liquid spray skin impregnation (SU-N20), a skin rub-on wax (SU-60), a surmount liquid glide wax (SU-100), a Pocket edger (TA3001), and a surmount ski strap (R0393). All products are packed in a small, light bag that fits perfectly in your backpack.

SU-N20 Surmount Skin Impregnation 150 ml, 10 pcs.

Protects alpine ski touring skins from icing and improves the glide properties. The risk of icing is in particularly present around zero degrees. Apply to the skin at least 15 minutes before skiing. For optimal performance, we recommend to let the skin impregnation cure overnight.

SU-100 Surmount Glidewax Liquid 100 ml, 10 pcs.

Surmount Glidewax has a sponge foam applicator on one side of the bottle for applying wax, and a felt pad on the other side for polishing. A handy bottle to carry in your backpack. Apply a thin layer over the base surface. Let it dry for approx. 2 minutes. Finish by polishing with the felt pad. Apply Surmount Glidewax to the steel edges when storing your skis or board after the season. This prevents the edges rusting.

SU-60 Surmount Skin Wax Rub-on 60 g, 10 pcs.

Surmount Skin Rub-on Wax is an easy to use wax to improve the performance of your climbing skins. Developed to enhance skin glide in soft snow conditions, and to reduce the uptake of dirt from the snow. Rub the wax well into the skins in a two-directional motion. After application the skins are ready to go. For very wet conditions we recommend to treat the skins with Surmount Skin Impregnation before applying the Surmount Skin Rub-on Wax.

R0393 Surmount Ski Touring Strap, 20 pcs.

Super tough and flexible strap for all purposes. Perfect for securing your skis to your backpack as well as holding your skis together. It also works perfectly as a brake retainer while tuning the edges of your skis. The strap stays flexible even in cold temperatures. Great product to always bring in your backpack. Length 50cm.

Nordic Easy Glide



N3NC 80 ml/2.7 US fl. oz. 15 pcs.

NORDIC EASY GLIDE LIQUID
For waxless skis. With applicator.



N4C 150 ml/5 US fl. oz. 10 pcs.

NORDIC SCHUPPEN SPRAY
For waxless skis.



N6C 70 ml/2.4 US fl. oz. 10 pcs.

ZERO 70 ECONOMY SPRAY
To be used in the kick section of touring classical skis with mechanical grip from factory or skis abraded with sandpaper. Let dry for two minutes. With upside down applicator.

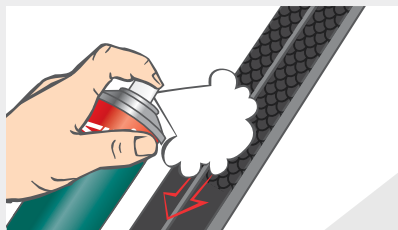

1: BEFORE SKIING

Apply Easy Glide on the total length of the ski base including the grip section. A one minute job. Go skiing!

Easy Glide will make the glide sections perform better and avoid icing in the grip section.

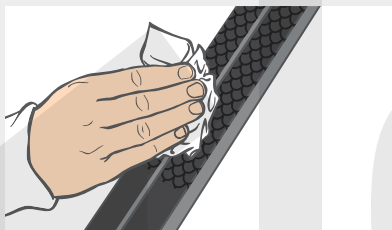

2: AFTER SKIING

Clean bases with Base Cleaner. Wipe off with Fiberlene cleaning towel.

Maintenance of waxless skis

Like waxable skis, waxless skis require maintenance. Waxless ski bases can dry out causing the base to oxidize and absorb dirt. Dirty oxidized skis are slower and harder to turn, creating more work for the skier. SWIX Easy Glide and Base Cleaner will solve this problem. Use these products to refurbish old waxless ski bases.

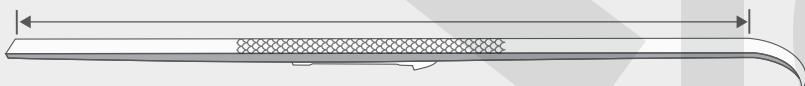

These products will over time get a new design. See and read more about this on page 6-11.



N21 80 ml/2.7 US fl. oz. 10 pcs.

SWIX SKIN BOOST

Improves the skins gliding properties. Fast and can be applied anywhere. Protects integrated skins from icing and improves glide properties. Recommended maintenance for skin skis to extend their life span and get a better ski experience. To be applied before skiing on a regular basis.

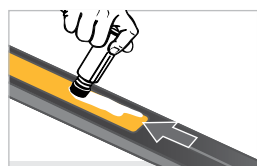

Rub gently into the skin in a tip-to-tail direction.

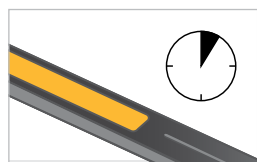

Wait 3 minutes before skiing.



N20 80 ml/2.7 US fl. oz. 10 pcs.

SWIX SKIN IMPREGNATION 80ml

Deep impregnation of your integrated skins. Long lasting. Improves water resistance and reduces dirt uptake. Developed to protect integrated skins from icing and to improve the glide properties. The risk of icing is in particular present around zero. To be used after cleaning the skins. Repeat after approx. 10 ski trips. Does not include Fiberlene.



N22 70 ml/2.37 US fl. oz. 10 pcs.

SWIX SKIN CLEANER

Removes dirt and wax residues picked up from the snow. Cleans integrated skins in a gentle way without affecting the skin glue. Restores the properties of -the skin and increases its efficiency. To be used after skiing. Includes Fiberlene.



Spray Skin Cleaner on Fiberlene paper.

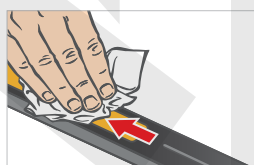

Clean the skin in a tip-to-tail direction.



N19 100 ml/3.38 US fl. oz. 10 pcs.

GLIDE WAX FOR SKIN SKIS

SWIX glide wax for skin skis is especially developed for skis with integrated skins, and is developed purely for the glide section of the ski. It is an all temperature product offering great gliding properties no matter what the weather conditions are. The practical foam applicator ensures a great product distribution, and the felt polisher at the bottle bottom ensures excellent product durability.

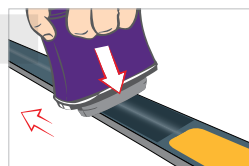

Rub gently into the skin.

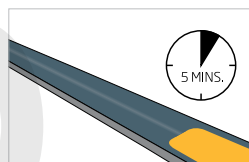

Wait 5 minutes before skiing.

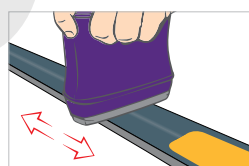

P15N

KIT FOR SKIN SKIS

Maintenance kit for skis with integrated skins. Contains Skin Boost (N21), Skin Cleaner (N22), glide wax (N19) and Fiberlene paper for application. Everything you need to get a better ski experience.

VG Base Binders

These products will over time get a new design. See and read more about this on page 6-11.

Base binders are designed to hold the hard kick wax on the base when the snow is coarse and abrasive.



New fallen snow
+1°C to -20°C (30°F to -4°F).



Transformed fine grained snow
+1°C to -20°C (30°F to -4°F).



Old snow
+1°C to -20°C (30°F to -4°F).

VG030 43 g/1.5 oz. 10 pcs.

BLUE BASE WAX

To be used as first layer for all hard kick waxes in new and fine grained snow. Easy to apply: Rub on and iron in with a waxing iron. Cork smooth.



Transformed fine grained snow
-1°C to -22°C (30°F to -7°F).



Old snow
-1°C to -22°C (30°F to -7°F).

VG035 43 g/1.5 oz. 10 pcs.

GREEN BASE BINDER

A flexible and practical Basewax for the VP and V-waxes for colder conditions than -1°C (30°F). To be used when the snow has been transformed (granular) and the wear on the wax is high. Rub on and iron in with a waxing iron. Cork smooth.



Transformed fine grained snow
-1°C to -22°C (30°F to -7°F).



Old snow
-1°C to -22°C (30°F to -7°F).

VGS35C 70 ml/2.4 US fl. oz. 10 pcs.

BASE BINDER SPRAY

A base binder spray for fine grained and transformed snow. It is applied by holding the bottle upside down and moved slowly along the skis kick-zone on both sides of the groove. The distance between the base and nozzle should be approx. 5 cm. Just apply a thin layer, wait a few minutes and add a few layer of kick wax for the conditions. You will then have a much more durable coating than with just the kick wax. Very convenient for training and when you don't have an iron available.

VP-Line Hard Kick Waxes

The VP waxes are made for top racing, but have also proved interesting for Recreational and Sport skiers because of excellent properties. The wax contains a new additive designed to impart maximum lubricity. This improves the stick-slip properties of the wax and gives an excellent feeling.

Each VP wax has two specified temperature ranges. One for falling and new fallen snow, characterized by sharp snow crystals with relatively strong penetration capacity. The other range is for older snow, when the crystals are rounded off and have less penetration power.

The VP line covers all temperatures from -10°C to +3°C.



- New and new fallen fine-grained snow
-8°C to -16°C (18°F to 3°F)
- Old/partly transformed snow
-12°C to -20°C (10°F to -4°F)

VP30

43 g/1.5 oz.

Min. 10.

Light blue kick wax designed for dry and cold to extremely cold conditions.



- New and new fallen fine-grained snow
-4°C to -10°C (25°F to 14°F).
- Old/partly transformed snow
-5°C to -14°C (23°F to 7°F).

VP40

43 g/1.5 oz.

Min. 10.

Blue kick wax designed for dry and cold winter conditions. A safe choice for normal midwinter inland conditions.



- New and new fallen fine-grained snow
-1°C to -5°C (30°F to 23°F).
- Old/partly transformed snow
-3°C to -8°C (27°F to 18°F).

VP45

43 g/1.5 oz.

Min. 10.

Purple-blue kick wax designed for normal winter conditions well below the freezing point. An obvious "next step" if VP40 does not provide a safe kick.



- New and new fallen fine-grained snow
0°C to -3°C (32°F to 27°F).
- Old/partly transformed snow
-1°C to -6°C (30°F to 21°F).

VP50

43 g/1.5 oz.

Min. 10.

Purple kick wax designed for conditions a few degrees below the freezing point. Provides perfect kick until you experience moderate shiny tracks.



- New fallen and finegrained snow
1°C to -2°C (34°F to 28°F).
- Old/partly transformed snow
0°C to -5°C (32°F to 23°F)

VP55

43 g/1.5 oz.

Min. 10.

Dark purple kick wax designed for moist, and new or new fallen snow around zero. Can also be used on older snow just below the freezing point without sacrificing glide.



- New fallen and finegrained snow
2°C to -1°C (36°F to 30°F).
- Old/partly transformed snow
-1°C to -4°C (34°F to 25°F).

VP60

43 g/1.5 oz.

Min. 10.

Purple-red kick wax working very well in moist, new snow and shiny tracks. Will also work on older, slightly transformed snow some degrees below the freezing point. If tricky conditions around zero, VP65 is recommended.

"The hook"

The lid of all SWIX hard kick waxes is equipped with a hook which makes it easier to tear the boxes.



- New fallen and finegrained snow
0°C to 2°C (32°F to 36°F).
- Old/partly transformed snow
0°C to -4°C (32°F to 25°F).

VP65

43 g/1.5 oz.

Min. 10.

Red/black kick wax with extraordinary properties when tricky conditions around the freezing point. Also brilliant on the cold side when high humidity and older/transformed snow. The black additive speaks for versatility and great anti-icing properties. VP65 works best on top of a couple of layers of a slightly harder wax. It also works great as a cover on top of klisters.



- New fallen and finegrained snow
0°C to 3°C (32°F to 38°F).
- Old/partly transformed snow
2°C to -1°C (36°F to 30°F).

VP70

43 g/1.5 oz.

Min. 10.

Yellow klister-wax designed for moist and beginning wet, new snow. Can also be used in moderate transformed snow until just below the freezing point. If you experience very wet, new snow or coarse transformed snow klister is recommended.

V-Line Hard Kick Waxes

Easy to use with two temperature intervals: NEW and OLD snow. Old, transformed snow is snow older than one day.

The V-Line of hardwaxes is the traditional line of hard kick-waxes, made for racing and recreational skiing. Although they do not have any fluorine

additives, their quality is very high due to fully refined petroleum waxes, synthetic rubbers and pharmaceutical quality oils. The V-waxes, in certain the cold-snow waxes are frequently used in top racing, alone or in combination with VR-waxes.

TIP: In old snow you always wax softer!

KICK ZONE FOR HARD WAXES - TOURING:

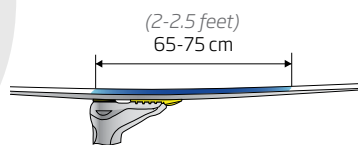

APPLICATION OF HARDWAXES

After finishing all brushing on the glide zones, sand the grip zone area with #120 grit sandpaper (SWIX T0011SP). This will make the difference for a long-lasting wax application.

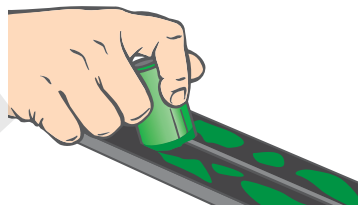

1: In cold conditions, the application normally starts by using VG30 or V40. More coarse grained snow normally requires a base binder as the first layer: VG35.

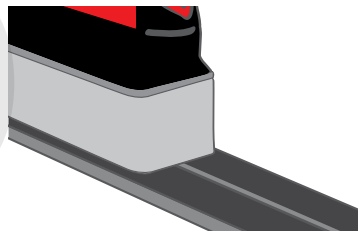

2: For extra durability: Iron the first layer of wax into the base. This process will increase contact between base and wax. Temperature setting of the iron is approx. 100°C.

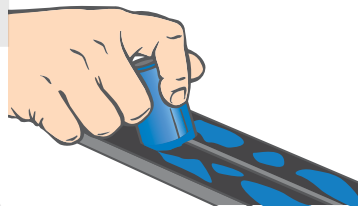

3: Select and apply the actual kick wax of the day. Preferably 4-8 thin, even layers. When 0°C (32°F) two layers are sufficient. Cork each layer.



- New fallen snow
-12°C to -25°C (10°F to -12°F).
- Old fine grained snow
-15°C to -30°C (5°F to -22°F).

V0005

43 g/1.5 oz.

Min. 10.

V05 POLAR

As the name indicates, this is hardwax made for the coldest conditions. Frequently used in the polar regions of Europe and North America.



- New fallen snow
0°C to -3°C (32°F to 27°F).
- Old fine grained snow
-2°C to -6°C (28°F to 21°F).

V0045

43 g/1.5 oz.

Min. 10.

V45 VIOLET SPECIAL

Also a very frequently used wax, both in racing and touring. When Blue Extra becomes somewhat slippery, a thin layer of Violet Special probably is the right wax.



- New fallen snow
-8°C to -15°C (18°F to 5°F).
- Old fine grained snow
-10°C to -18°C (14°F to 0°F).

V0020

43 g/1.5 oz.

Min. 10.

V20 GREEN

The well known cold snow wax, used for more than fifty years, has been modernized several times with new components.



- New fallen snow
0°C (32°F).
- Old fine grained snow
-1°C to -3°C (30°F to 27°F).

V0050

43 g/1.5 oz.

Min. 10.

V50 VIOLET

For many years a secret weapon in the wax-box of World Cup Servicemen. To be used when the snow is in a stage going from cold to wet, around freezing (32°F).



- New fallen snow
-2°C to -10°C (28°F to 14°F).
- Old fine grained snow
-5°C to -15°C (23°F to 5°F).

V0030

43 g/1.5 oz.

Min. 10.

V30 BLUE

Another truly classic SWIX wax. To be used on moderate cold snow when skiing is at its best.



- New fallen snow
0°C to +1°C (32°F to 34°F).
- Old fine grained snow
0°C to -2°C (32°F to 28°F).

V0055

43 g/1.5 oz.

Min. 10.

V55 RED SPECIAL

For moist new snow up to +1°C (34°F) and down to -2°C (28°F) in older more transformed granular snow.



- New fallen snow
-1°C to -7°C (30°F to 19°F).
- Old fine grained snow
-3°C to -10°C (27°F to 14°F).

V0040

43 g/1.5 oz.

Min. 10.

V40 BLUE EXTRA

The most popular V-wax. A very flexible and versatile wax covering a large temperature-range on the cold side of freezing. To be utilized close to 0°C, demands relatively new snow and low air humidity (below 45-50%).



- New fallen snow
0°C to +3°C (32°F to 37°F).
- Old fine grained snow
+1°C to -1°C (34°F to 30°F).

V0060

43 g/1.5 oz.

Min. 10.

V60 RED/SILVER

For wet new snow up +3°C (38°F) and down to -1°C (30°F) in older more transformed granular snow. Apply thicker the warmer it is to secure grip.

NERO Klusters



Moist fine
grained snow



Transformed
moist fine
grained snow



Frozen corn
snow

KN33

55 g/1.9 oz. 10 pcs.

NERO

+1°C to -7°C (34°F to 19°F).
Klister for competition and training.



Wet corn
snow



Transformed
moist fine
grained snow



Frozen corn
snow

KN44

55 g/1.9 oz. 10 pcs.

NERO

-3°C to +5°C (27°F to 41°F).
Klister for competition and training.

Revolutionary klusters with a black ingredient that has shown an impressive performance. The key properties are enhanced in all aspects of the products

VERSATILE

It can handle changing snow conditions very well and it has great anti-icing properties.



EXCELLENT DIRT MANAGEMENT

It collects significantly less dirt from the snow than traditional klusters.



NO FLOATING KLISTER

It is durable and stays better within the kick-zone than other klusters.



GREAT KICK OVER TIME

It provides a secure kick over longer time than traditional klusters, due to its special characteristics.



KX Klister Line

These products will over time get a new design. See and read more about this on page 6-11.

This is a complete klister line based upon formulas that has a logical build up going from hard to soft, from cold corn snow to extreme wet corn snow. The higher the number, the softer the wax.

The KX line is designed for top level competitions as well as recreational skiing.

- Better kick and glide!
- More fun - less mess.
- New packaging.
- Smaller opening on tubes for better control when applying.
- Includes scraper.

APPLICATION OF KLISTER

Sand the kick zone with #100/120 grit paper.

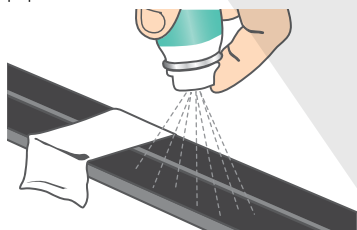

1 | Apply the base klister very thin, just covering the sandpapered area.

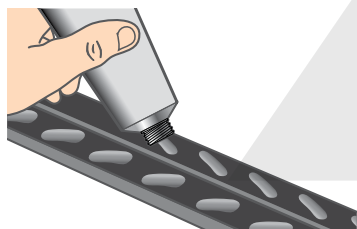

2 | Select and apply the klister of the day. One layer normally is enough. The product is applied in a "fish-bone"-like pattern, or as a thin string on each side of the groove. Use your fingers, the T0087 scraper or the KP10 klister brush to even out the klister.



KP10

KLISTER BRUSH, 2 PACK

Package includes two klister brushes for evening out klisters on the ski base. Gives the perfect end result. Red brush for KX65 and KX75 klisters, and black brush for Universal, and KX20 to KX45 klisters.



Frozen corn snow



Wet corn snow

KX20

55 g/1.9 oz. 10 pcs.
BASE KLISTER. Green.

Base klister for cold and warm conditions. To be used as first layer for other klisters. Always to be applied thin with an iron or heat gun. High wear resistance and adhesion.



Frozen corn snow

KX30

55 g/1.9 oz. 10 pcs.
BLUE KLISTER
-4°C to -12°C (25°F to 10°F).

For frozen, icy tracks and cold conditions. Can be used as base klister on wet snow.



Transformed moist fine



Moist fine grained snow



Frozen corn snow

KX35N

55 g/1.9 oz. 10 pcs.
BLUE EXTRA KLISTER
0°C to -8°C (32°F to 18°F).

Versatile klister, more tolerant to colder and fine grained snow than the earlier version (KX35). Hard and durable. As a top layer klister it performs best on fine grained snow from around the freezing point and colder. Also great as a middle layer klister on top of KX20 or KB20, covered with kickwax, or as a top layer universal klister.



Frozen corn snow



Wet corn snow

KX45N

55 g/1.9 oz. 10 pcs.
VIOLET SPECIAL KLISTER
+1°C to -4°C (34°F to 25°F).

Particularly suitable for coarse-grained snow when the air temperature goes from minus to plus. Also used as a middle layer on top of KX20 or KB20, before wet-snow klister is applied as a top layer.



Moist fine grained snow



Frozen corn snow

KX40S

55 g/1.9 oz. 10 pcs.
VIOLET SILVER KLISTER.
+2°C to -4°C (36°F to 25°F).

Developed for transformed and fine grained snow. Very good when warmer than 0°C and relatively fine grained snow. The klister that goes the farthest into dry snow without icing!



Wet corn snow

KX65

55 g/1.9 oz. 10 pcs.
RED KLISTER
+1°C to +5°C (34°F to 41°F).

For wet and moist coarse corn snow.



Very wet corn snow

KX75

55 g/1.9 oz. 10 pcs.
RED EXTRA WET KLISTER
+2°C to +15°C (36°F to 59°F).

Wet snow klister. Used when the snow has a high water content such as slush, and the air temperature is well above freezing. Late spring klister.

KB Base Binder

These products will over time get a new design. See and read more about this on page 6-11.

Unlocking the secrets of base binder

It's not just about ensuring your kick wax stays put during icy challenges or long distance races; it's about optimizing every kick you make. For the ideal waxing experience with your kick skis, always begin with a base binder. Dive deeper into our VG-VP concept to explore more of our binders.

Base binders are designed to hold the hard kick wax on the base when the snow is coarse and abrasive.



KB20C	70 ml / 2.4 US fl. oz.	10 pcs.
KB20-150C	150 ml / 5 US fl. oz.	10 pcs.

GREEN BASE KLISTER SPRAY

Makes other klister last longer! First klister layer to be applied. To be used with regular klister on top, or aerosol Quick Klister. For Racing, Sport and Recreation. Used in World Cup.



Frozen corn (old) snow
-15°C to +10°C (5°F to 50°F).



Wet corn snow
-15°C to +10°C (5°F to 50°F).

Upside down spray applicator for controlled spray-on application. The Base klister is applied by holding the bottle upside down and move it slowly along the ski on both sides of the groove. Distance between the base and nozzle should be 4-5 cm.

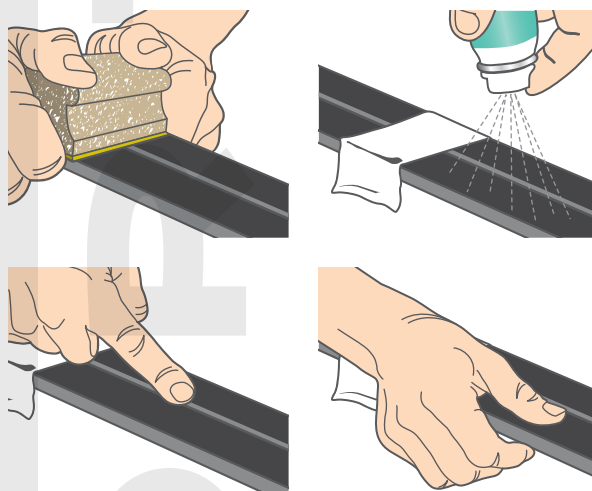

KX Klister Line

These products will over time get a new design. See and read more about this on page 6-11.



K65C 150 ml/5 US fl. oz. 10 pcs.

UNIVERSAL QUICK KLISTER
-5°C to +10°C (23°F to 50°F).
Quick and easy application. Ideal for applying when you need more wax on the trail.

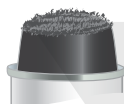

K70C 150 ml/5 US fl. oz. 10 pcs.

RED QUICK KLISTER
0°C to +15°C (32°F to 59°F).
For very wet granular snow.
Easy to apply as K65C.



Wet corn snow



Frozen corn snow

K2255 g//1.9 oz. 10 pcs.

VM UNIVERSAL KLISTER
+10°C to -3°C (50°F to 27°F).
For coarse, granular snow changing from wet to crust. A very popular and "flexible" klister. Used in racing as well as recreational skiing.



Wet corn snow



Frozen corn snow



Moist fine grained snow

K215 55 g//1.9 oz. 10 pcs.

SILVER UNIVERSAL KLISTER
+3°C to -5°C (38°F to 23°F).
A very flexible klister with silver, working on both sides of freezing when conditions are changing between coarse and transformed moist to wet fine grained snow.

Tip: Klister Application

For optimal klister application, work indoors and ideally at room temperature. This ensures the klister remains pliable and easy to handle.

Tools like a waxing table, waxing profile, waxing iron, heat gun, and the T60 Wax Machine streamline the process and enhance the result. Read more about the wax machine further down in the workbook.

Begin with applying a base klister - KB20C serves as an outstanding binder. You can directly spray it onto the ski.

Kits

These products will over time get a new design. See and read more about this on page 6-11.



P17
LIQUID GLIDE KIT

Ski waxing has never been easier. This kit contains two liquid gliders which you just spray on your skis for excellent glide.

Content: HS06L-12, HS08L-12 and T0166B



P0027 10 pcs.
WAXPACK
Content: V40, V55, K22, T10 in zip lock bag.



P0019 10 pcs.
GUNDE PACK
Content: V40, V45, V55, T10 in zip lock bag.



P0034 1 pcs.
WAXPACK
Content: V40, V60, K22, T10, T151, I61C, T87
2 pcs. In fanny pack.



P21N
GLIDE & EDGE KIT
A basic kit of essentials for a day on the slopes. The TA3001N file guide, which comes in a handy pocket format, can sand the ski edges to either 87 or 88 degrees and gives a very good end result on the steel edges.

The Quick glide wax F4-23-100 is super easy to apply and works well at all temperatures. The polishing felt at the bottom of the bottle should be used lastly for even greater durability.



P19N
SKIN & LIQUID GLIDE KIT
A kit for skin care and liquid glide.
Great ski care in no time.
Content: HS06L-12, HS08L-12, T0151, N21, N22 and T0166B

Wax Cases and Wax Kits



T440F HOT WAX KIT

Swix Hot Wax Kit is filled with all necessary equipment you need to start hot waxing your skis.

Hot waxing is the next level of taking care of your skis and snowboard and improving the performance for even more fun, whether you do cross-country skiing, alpine skiing or snowboard. The kit contains T77 Waxing iron Economy, PS6 Blue (60g), PS8 Red (60g), T824 D Plexi Scraper, T162B Bronze brush, T87 All purpose scraper and T151 Fiberlene paper. All products are perfectly fitted into a 100% recycled plastic case.



T006B 40 cm x 31 cm x 8 cm. Ea.

WAX BOX MEDIUM, empty.
Universal wax box with foam inside. For Nordic and Alpine.



T64-3

MEDIUM WAX CASE XC, empty.

Wax Cases Nordic



T64-3F

MEDIUM WAX CASE XC, FILLED

Perfect kit for the cross-country enthusiast.
 Filled up with kickwax, klister and liquid glide wax for all conditions.
 The box contains eight kickwaxes, four klisters, two liquid gliders, scraper, cork, basecleaner, sandpaper, fiberlene paper and brush.

Products in kit: Kick waxes: VG35, V20, V30, V40, V45, V50, V55 and V60.
 Klister: KB20C, K21S, K22N and KX75. Liquid gliders: PS6L-80 and PS8L-80. Basecleaner I61C. Cork T11. All purpose scraper T87, Cork/ Nylon brush T196B. Fiberlene paper T151.



T550

37 cm x 56 cm x 15 cm. Ea.

PRACTICAL WAX BOX FOR CROSS COUNTRY!
 Especially designed compartments for hard waxes, klister, glide waxes, cleaners, brush-es, scrapers, corks, structure tools. Delivered without wax.



(Delivered without wax)

- Available in Non-ozone depleting aerosols
- Lightly scented
- Dearomatized hydrocarbons
- Available in many sizes to fit your budget
- Available in bulk
- Available in Citrus based formula
- Increased product shelf life

These products will over time get a new design. See and read more about this on page 6-11.



I74N
CITRUS SOLVENT BASE
CLEANER, liquid.

500 ml/16.9 US fl. oz. 10 pcs.



I91C.
BASE CLEANER SET,
25 pcs containing
I62C and T151
Fiberlene.



T0150
FIBERLENE CLEANING TOWEL
Large roll
40 m/130 feet.



I61C
BASE CLEANER,

70 ml/2.5 US fl. oz. 10 pcs.
aerosol.



I25 HAND CLEANER

HAND CLEANER CREAM
75 m 100% natural product.
Very effective for removing
klister and other dirt!
Practical tube, 75 ml.



T0150B
FIBERLENE CLEANING TOWEL
X-large roll.
200 m/650 feet. 1 pcs.



I64N
BASE CLEANER, liquid.

500 ml/16.9 US fl. oz. 10 pcs.



I63C
150 ml/5 US fl. oz. 10 pcs.

BASE CLEANER
with Fibertex scrub
applicator for efficient
removal.

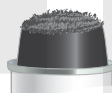

T0151
FIBERLENE CLEANING AND
IRONING TOWEL
20 m/65 feet. 15 pcs.



I67N
1000 ml/33.8 US fl. oz.
10 pcs.

BASE CLEANER, liquid.

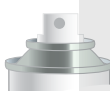

I62C
150 ml/5 US fl. oz. 10 pcs.
BASE CLEANER,
aerosol.



T0156P-24 NEW
Racing Polishing cloth 20m

*Illustration may vary from
actual product*

Removers, cleaners and care products

These products will over time get a new design.
See and read more about this on page 6-11.



I84-70N

70 ml/2.4 US fl. oz. 18 pcs.

CLEANER FOR GLIDE WAX
/ CONDITIONER FOR RACING SKIS



I84-150N

150 ml/5 US fl. oz. 10 pcs.

CLEANER FOR GLIDE WAX /
CONDITIONER FOR RACING SKIS,
liquid. Pump spray (no propellant liquid).



I94

PRO CLEANER 250ml, 1 pcs.

NEW

The new Pro Cleaner is designed to effectively remove fluoros, dirt, wax, and silicones from the ski while adding a thin and strong protective wax layer on the ski base. The Norwegian Ski Association's wax team recommended using Pro Cleaner to remove fluoros from the ski base. The image may differ from the actual bottle.



I84N

GLIDE WAX CLEANER /
CONDITIONER FOR RACING SKIS
500 ml liquid, 1 pcs.

Cleaning your ski base



1: Brush lightly with the Steel Brush (T0179).



2: Moisten a piece of Fiberlene (T0150) and apply to the glide zone of the base.

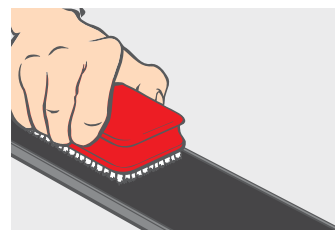

3: Rub forward and backward a few times with a Steel Brush (T191B).



4: Wipe off as much as possible with Fiberlene (T0150).



Let the ski dry for 5-10 minutes.

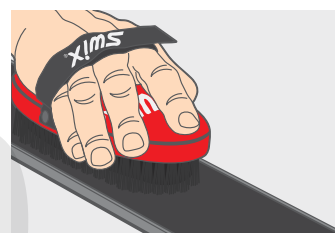

5: Brush firmly with the Steel Brush (T0179 or T0162). The ski is now ready for application of new glide wax.

Surface tools

CORKS



T0012
SYNTHETIC RACING CORK
with higher density. Min. 10.



T0020
GLIDE WAX CORK
Natural cork. Min. 10.



T0021
Combi Felt and Cork.
For application of liquids.



T0011
Synthetic Combi Cork with #120 grit sandpaper attached with Velcro®. A combi cork with sandpaper to be used on the kick zone before applying kick wax; Will make the kick wax adhere better to the base. Min. 10.



T0022
Snowboard polishing cork. Min. 10.



T0023
Snowboard Combi Felt and cork.
For application of liquids.



T0011SP
Replacement sandpaper #120 for T0011.
3 pcs. Min. 10.



KP10
KLISTER BRUSH, 2 PACK
Package including two klister brushes for even out klister on the ski base. Gives the perfect end result.

Red brush for KX65 and KX75 klisters, and black brush for Universal, and KX20 to KX45 klisters.

SANDING PAPER

There are many uses for sandpaper with skis and boards. For alpine, freeride, and boards the fine abrasive papers can be wrapped around a file and used to deburr and polish the edges. Sandpaper can be used to dull the edges at the tip and tail to reduce erratic handling of skis and boards. Sandpaper can also be used after polyethylene repairs to the base to blend the repair into the base and add some texture (structure). It is also possible the sand the entire base surface of skis and boards to remove scratches and old oxidized material. However, deburring, or removing polyethylene micro fibers, with Swix Fibertex is very important following base sanding.

Swix has selected silicon carbide abrasives for its sandpaper. This very hard and sharp abrasive is best suited for working on bases and edges.

SANDING PAPER FOR MAKING ZERO SKIS

To be used on normal skis to make your own mechanical grip when 0°C and falling moist snow. Size 45 mm x 66 mm. Fits corker T0011.



T0306
3 pcs. #60 paper.
Normally first paper on falling wet snow.



T0308
3 pcs. #80 paper. Second paper.
To be used after #60.



T0330
5 pcs. #100. Ea.



T0350
5 pcs. #180. Ea.



ACRYLIC PLEXI SCRAPERS



3 mm

T0823D
Plexi scraper, 3 mm. Min. 10.



4 mm

T0824D
Plexi scraper, 4 mm. Min. 10.



5 mm

T0825D
Plexi scraper, 5 mm. Min. 10.



SB034D
Snowboard plexi scraper. Min. 10.

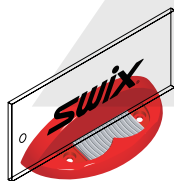

T0408
Plexi Sharpener. 40 mm.



T410
PLEXI WORLD CUP SHARPENER
Two walls for stable position makes it easy to sharpen precise. With long 100 mm quality file.

GROOVE & SIDE EDGE SCRAPERS



T0087
Groove/All purpose scraper in polycarbon.
Min. 10.



T0088
Pencil groove scraper. Min. 10.

CORK & SCRAPERS FOR RECREATION



T0035
Handy scraper. For hardwax and klister.
Cross country. Min. 10.



T0030
Universal scraper with bottle opener. Min. 10.



T0086
Plastic scraper for removal of kick wax or wax on the sides. Min. 10.

METAL SCRAPERS



T0080
Steel scraper for peeling or straightening bases. Min. 10.



T412-220-24
World Cup El. Scraper Sharpener 220V

NEW

Brushes

RACING



T0019S

STEEL BRUSH, 100 MM, 1 pcs.

To refresh bases before waxing. Second brush on wax after horsehair T0016M. The steel brush is used as the first brush after hot waxing and scraping before the horsehair brush. And also for deep cleaning of the base after cleaning the glide zone. For really soft waxes, we recommend using a horsehair brush as the first brush before using the steel and then finishing with the horsehair or nylon brush. We recommend using a drill with a minimum rotation speed of 1800 rpm for best results. Move the brush in overlapping movements from the tip to the tail of the ski. Warning: We recommend lightly dulling a new roto steel brush with sandpaper #100 before using it for the first time. The steel brush should always be used in the same rotating direction.



T0016M

HORSEHAIR BRUSH, 100 MM, 1 pcs.

The horsehair brush is mainly used as the second brush after steel when brushing out the wax after hot waxing. We recommend using a drill with a minimum rotation speed of 1800 rpm for best results. Move the brush in overlapping movements from the tip to the tail of the ski.

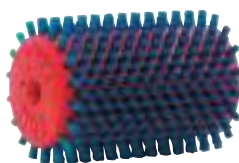

T0017W

BLUE NYLON BRUSH, 100 MM, 1 pcs.

The nylon brush is a universal brush for the final polishing of the base after applying liquids, hot waxes, or using roto fleece. We recommend using a drill with a minimum rotation speed of 1800 rpm for best results. Move the brush in overlapping movements from the tip to the ski's tail.



T0018F-2

HARD ROTO FLEECE, 100 MM, 1 pcs.

For top coats. The roto Fleece is an excellent brush for improving the performance and durability of liquid glide waxes. Always do the final polishing with a nylon brush after using the roto fleece. We recommend using a drill with a minimum rotation speed of 1800 rpm for best results. Move the brush in overlapping movements from the tip to the ski's tail. Warning: Don't put too much force against the base when roto fleecing since this will create a lot of heat and possibly damage the base.



T18W-140

ROTO BRUSH MERINO WOOL, 140MM, 1 pcs.



T18W

ROTO BRUSH MERINO WOOL, 100MM.

The World Cup version of roto wool. Longer hair and more fluffy. The first choice for for applying TS Turbo.

TIPS

- It is recommended to use separate brushes for paraffin type waxes from brushed used for powders.
- Always use safety glasses when Roto brushing.
- Don't press down too hard. Let the brush do the work.
- Brush from tip to tail with the brush rotation throwing the wax particles towards the tail.



T0019S-XC

STEEL BRUSH, 70MM, 1 pcs.



T0016M-XC

HORSEHAIR BRUSH, 70MM, 1 pcs.

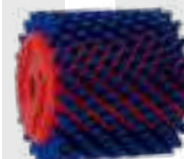

T0017W-XC

BLUE NYLON BRUSH, 70MM, 1 pcs.



T0018F-XC

HARD ROTO FLEECE, 70MM, 1 pcs.



T18W-100

ROTO BRUSH MERINO WOOL, 100MM, 1 pcs.

A new and revolutionary way of applying waxes without the need of a waxing iron. The method is tailor-made for harder waxes, such as the Marathons, or TS Turbo, and is applied onto the skis in a few simple steps: Start by applying the glider to the roto wool by pressing the wax block against half the width of the roto wool while running the drill at a low speed. Use the waxed side of the roto wool on the ski with medium pressure and medium drill speed. Start with the back of the ski, and continue with the front. Finish off by polishing the whole ski with the clean side of the roto wool. Use very light pressure and maximum drill speed.

ROTO COVER WITH SUCTION

- A totally redesigned cover with air suction functionality.
- Creates a strong vacuum around the brush, and removes close to 100 % of all particles that occurs during roto brushing.
- The air suction functionality is a great add-on to take care of the working environment in the waxing cabin. Highly recommend able for professional waxers.

NEW

T15-100 100 mm 1 pcs.
T15-140 140 mm 1 pcs.

T15-LN 100 mm, 1 pcs.
 Racing Twist Lock for Roto Cover. L-bend twist-lock adapter for connecting SWIX roto covers to Swix Snap-Lock and our suction system.

ROTO COVER W/SUCTION

Ergonomic roto handles with driveshaft and protective cover, that fits SWIX' 100mm and 140 mm roto brushes.



T0014HPS-3
 Handle, cover, shaft.
 100 mm, 1 pcs.



T0015HPS-3
 Handle with driveshaft 140 mm and protection cover. For 140 mm brushes double Roto brushes 70 mm + 70 mm, 1 pcs.



T0050
GRIP COVER 100 mm, 1 pcs.
 A highly practical cover to protect the skin section while hot waxing in the glide section. Also ideal when traditional kick wax or klister has been applied, and it is needed to re-wax the glide section. Very easy to attach to the ski with 4 tightening clamps. Length can be adjusted from 45-68 cm.



T0014HN-3 1 pcs.
ROTOHANDLE
 Handle for Roto brushes without drive shaft. Features two inner ball bearings for optimum stability. Fits all Swix hexagonal drive shafts.



T0012PS-3 100 mm 1 pcs.
 Cover for rotobrush, 100mm
 Protective cover for Roto brushes, 100 mm.



T0014SS
 Hexagonal drive shaft, 100 mm, 1 pcs.



T0014SM
 Hexagonal drive shaft, 140mm, 1 pcs.



T0014SL
 Hexagonal drive shaft, 210 mm, 1 pcs.

RACING









There is a wide selection of Swix brushes. They are made at different price levels with different qualities depending on whether you are in the sport/recreational category or into high level racing having to do many skis or boards in a short time.

Swix brushes are designed for brushing wax out of the structures (base patterns) in ski bases and snowboards after you have used the plexi scraper. Should be used in one direction, from tip to tail.

Two brushes are enough for standard waxes:

- After scraping the wax with a plexi scraper use a steel brush (T0179) or a bronze brush (T0162). Steel is more efficient and longer lasting than bronze. The "after scraping brush" is the most important brush!
- For finish use a fine nylon brush (T0160).

SWIX BRUSH CHART - ALPINE AND CROSS COUNTRY

WORLD CUP					
	T0179B	T0191B	T0160B		
RACING					
	T0162B	T0157B	T0160B	T0196B	T0190B
BASE					
	T0159B	T0161B	T0166B		

AFTER SCRAPING

T0191B

RECTANGULAR FINE STEEL BRUSH, 1 pcs.
 Ø 0.06 mm. Ultra fine bristles. Goes deep into the base structure. Cleans and refreshes the base. Often used as second brush on wax. 4 to 5 strokes.

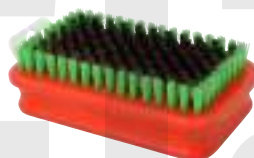

T0191B

T0179B

RECTANGULAR STEEL BRUSH, 1 pcs.
 Ø 0.18 mm. Used as first brush on wax after scraping. 5-6 strokes. High quality steel brushes that has had an excellent reception in racing.



T0179B



T01790

T01790

OVAL STEEL BRUSH, 1 pcs.

T01580

OVAL COARSE BRONZE BRUSH. Ø 0.18 MM, 1 pcs.
 For alpine skis and snowboard. Use as a first brush on wax after scraping. For removing wax in the structure. 10 brush strokes recommended.



T01580

T0162B

RECTANGULAR MEDIUM BRONZE BRUSH, 1 pcs.
 Ø 0.15 mm. First brushes used after scraping. 10 strokes.

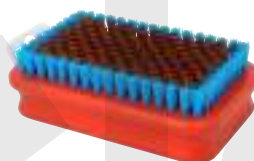

T0162B

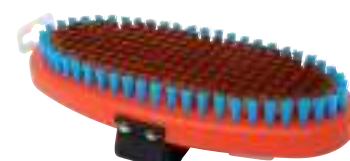

T01620

T01620

OVAL MEDIUM BRONZE BRUSH, 1 pcs.

T0160B

RECTANGULAR FINE BLUE NYLON BRUSH, 1 pcs.
 Ø 0.12 mm. Polish brushes for all waxes. 5 to 10 strokes.

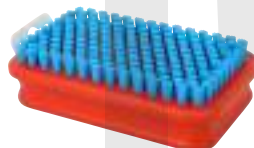

T0160B

T0190B

RECTANGULAR FINE RED NYLON BRUSH, 1 pcs.
 Ø 0.12mm. Special developed for polish liquid waxes. Fine bristles that goes deep in the structure and make a smooth and glossy surface. Can be used as a final step polishing for all types of wax.



T0190B



T01900

T01900

OVAL FINE RED NYLON BRUSH, 1 pcs.

BASE (ECONOMY) BRUSHES

T0157B
 RECTANGULAR HORSEHAIR, 1 pcs.
 Ø ca. 0.15 mm. Second brush or all round brush on top coat. 5 to 10 strokes.



T0157O
 OVAL HORSEHAIR BRUSH, 1 pcs.



T0196B
 COMBI BRUSH / CORK AND NYLON, 1 pcs.
 For application of rub-on waxes.
 This brush has natural cork on one side and short, fine nylon bristles on the other



T0161B
 Nylon, all round brush, 1 pcs.

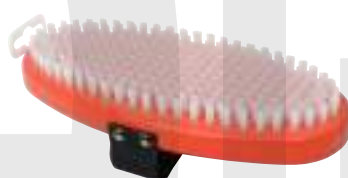

T0161O
 Nylon, all round brush, 1 pcs.

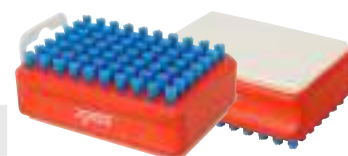

T0166B
 F4 COMBI BRUSH, 1 pcs.
 This is the ideal brush when applying any F4 product. White felt for spreading the F4 product evenly on the base and for polishing. The nylon for brushing and removing excess wax from the structure. This process can increase the durability of any F4 product.

THERMOMETER / HYGROMETER

T0095
 Snow thermometer with protective case. Ea.

POLYSTICKS

T1716 Ø 6 mm
 Polystick, black. One package: 4 pcs.

T1716B Ø 6 mm
 Polystick, black, bulk. One package: 10 pcs.

T1706 Ø 6 mm
 Polystick, transparent. One package: 4 pcs.

T1706B Ø 6 mm
 Polystick, transparent. One package: 10 pcs.

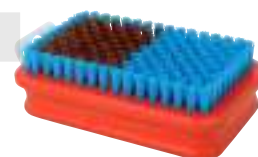

T0159B
 Combi. Bronze and Nylon, 1 pcs. All round brush.

SWIX FIBERTEX

T0266
 3 Pads. 110 x 150 mm 10 pcs.
 Fibertex Fine. White. To remove polyethylene hairs after stone grinding



T0266N
 3 Pads. 110 x 150 mm 10 pcs.
 Fibertex Coarse. Violet. For Scratched and damaged bases. Finish with T0264N and T0266

Cross Country Structure Tools

BASE



T0401U

SWIX SUPER RILLER LINEAR (BASE)

The first commercial rilling tool on the market and still popular. When warmer than 0°C, the 2 mm structure steel is used. Gives a major improvement. Blisterpacked. Ea.

T0401-1U

1 mm insert structure steel (standard), 1 pcs.

T0401-2U

2 mm insert structure steel, 1 pcs.

Hand made structure tools are used more and more. The advantage is that you can adjust good skis with fine and medium stone grinded structures to warmer conditions. This means fewer skis to travel around with.

Scrape the glide wax, brush and lastly set the structure.

Most hand set structures will disappear after rewaxing with iron.

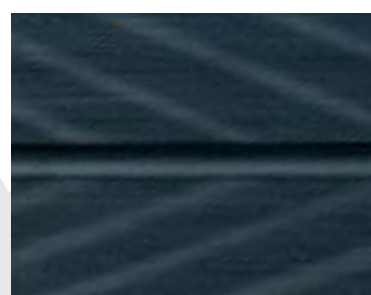

RACING



T0424

STRUCTURE ROLLER TOOL, 1 pcs.

An ergonomic, high quality structure tool for cross-country skis. Easy to change between different rollers. All rollers have ballbearings for easy rolling. Delivered with 1mm linear structure roll. An arrow shows the correct direction of movement. Structure imprint will disappear after rewaxing with iron. For all levels. Structure rollers from T0410 fit to this handle and can be used if you want more options.

T0424S

Structure kit with three rollers, 1 pcs.

T0424050V, 0,5mm for very cold snow.

T0424100G, 1,0mm linear for cold snow.

T0424200G, 2,0mm linear for wet snow.



T0424050V

0,5mm broken structure roller, 1 pcs.



T0424100G

1,0mm linear structure roller, 1 pcs.



T0424200G

2,0mm linear structure roller, 1 pcs.

Structure Tools

WORLD CUP



T0410

WC ADJUSTABLE STRUCTURE TOOL, 1 pcs.

Consistent pressure when structuring a ski base is very important and the new Swix structure tool allows you to set the pressure that is maintained throughout the process. The set comes with 4 different rollers. 1.0mm G, 1.0mm SR, 1.5mm SR and 0.5mm broken V structure roller. The Swix Structure tool will give you consistent structure and will improve the glide on both skating and classic skis. In cold new snow, we recommend you set the tool on lighter pressure and in warmer conditions and transformed snow, we recommend greater pressure. You can easily adjust the pressure by moving the handle on the side up and down. **Made in Norway.**

Included structure rollers are:

- T0410-050V. 0.5mm broken V structure
- T0410-100G. 1.0mm linear structure
- T0410-100SR. 1.0mm thread right
- T0410-150SR. 1.5mm thread right



T0410-030V



T0410-050V



T0410-100V



T0410-050G



T0410-075G



T0410-100G

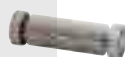

T0410-200G



T0410-050SR



T0410-100SR



T0410-150SR

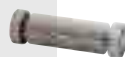

T0410-050SL



T0410-100SL



T0410-150SL

Additional rollers: , (1 pcs.)

T0410-030V. 0.3mm V structure

T0410-050V. 0.5mm V structure

T0410-100V. 1.0mm V structure

T0410-050G. 0.5mm linear structure

T0410-075G. 0.75mm linear structure

T0410-100G. 1.0mm linear structure

T0410-200G. 2.0mm linear structure

T0410-050SR. 0.5mm thread right

T0410-050SL. 0.5mm thread left

T0410-100SR. 1.0mm thread right

T0410-100SL. 1.0mm thread left

T0410-150SR. 1.5mm thread right

T0410-150SL. 1.5mm thread left

File Guides and Sidewall Cutters

BASE



TA3007

SWIX PHANTOM EDGE FILE HOLDER

Economy side edge sharpener with 80 mm file. Easy adjustment from 85 to 90 degrees. Ergonomic, longer holder for stability and good grip. Protects the hand. Takes files and stones up to 6 mm thickness. Easy tightening of files.



TA3001N

POCKET EDGER

Pocket size file holder with 40 mm file. Side-edge 87 and 88 degrees. Easy to work with. Blister packed.



TA3010SD

SPARE DIAMOND 80mm.
Spare part for TA3010N.



TA3010SA

SPARE ABRASIVE 80mm.
Spare part for TA3010N.



TA3010N

COMPACT EDGER KIT

Ergonomic file holder with 80 mm file, Diamond stone for polishing and abrasive stone for deburring the edge. Ski brake retainer included.



TA3005N

POCKET EDGER KIT

Pocket size file holder with 40 mm file, diamond stone for polishing and abrasive stone for deburring the edge. Ski brake retainer included.



TA3010SF

SPARE FILE 80mm.
Spare part for TA3007, TA3008, TA3009N, TA3010N.



TA3005SD

SPARE DIAMOND SQUARE.
Spare part for TA3005N.



TA3005SA

SPARE ABRASIVE SQUARE.
Spare part for TA3005N.

CROSS CONCEPTS



TA3006

MULTI EDGER

The Swix multi edger tool is all you need to sharpen and bevel your edges. You can set up the base and side edge in one tool! Dial a precise side angle from 0 to 5 degrees and 0.5 to 1.0 degrees on the base—nine different angles in total. Always set the base edge angle before the side edge angle. We add a bevel to the base edge to make the skis more predictable or forgiving and bevel the side edge to give more grip on hard snow and ice.



€ 35,00 - 70,00